

MECHLIFT ML220R Bin Lifter



The **ML220R** or “*Rocker lifter*” is the first demountable lifter pair, where the frame and lifting mechanism are combined in one unit. This reduces the weight, costs, installation time, and makes for a more robust lifter. One of the main advantages of the demountable lifter is that it can easily be fitted or removed, this in turn means reduced downtime and greater flexibility.

The **ML220R** is a split “**high –level**” lifter, which means that you can continue emptying bins whilst the truck is compacting. As a result you can empty over 1200 bins per 8-hour shift with this lifter.

The ML220R is supplied as a complete unit, ready for mounting on the vehicle. All that the vehicle requires is for the base plates to be fitted and the side locking-plates to be added. No additional bodywork is needed.

The lifter kinematics used in the **ML220R**, are the same as the tried and tested ML220 (which has proven to be the most popular high level lifter in Southern Africa). Each lifter is driven by a single **rotary actuator** and housed in it’s own carrier frame, this means that they are interchangeable (left or right side), easily removed for servicing and the truck can even continue working with a single lifter. A winch overload protection clutch allows you to use the trucks roof winch to raise and lower the lifter without the risk of bending the lifters frame. (see diagram below)

As with all Mechlift lifters, you will find that mostly standard parts are used, this means spares are readily available and affordable. The **ML220R** has been locally designed and manufactured for South Africa’s unique conditions, whilst complying to European and DIN bin standards.

No tools are required to remove or re-fit the lifter and because of the unique “rocker” design, once the lifter is on the ground, it can easily be moved and manipulated by a single operator. This makes servicing skips a pleasure and means that the lifter is easily interchangeable.

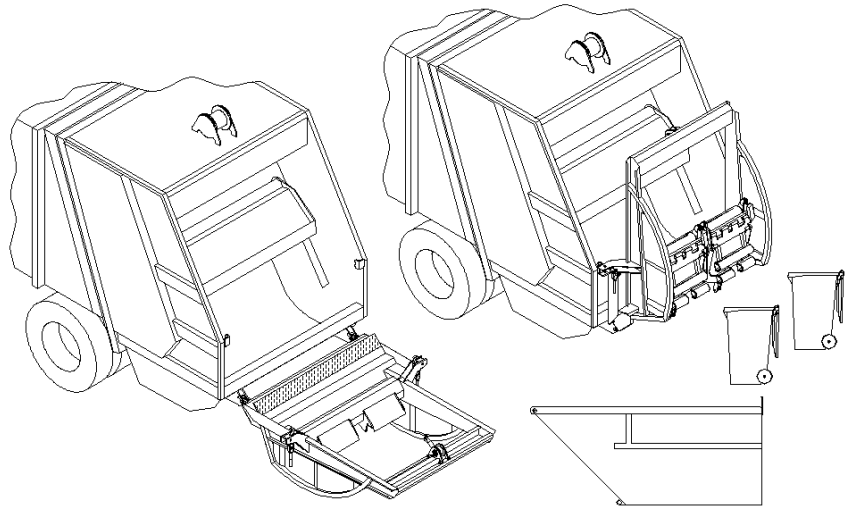

FOR MORE COMPREHENSIVE INFORMATION, CONTACT:

MECHLIFT (Pty) Ltd, 84 Mobile Road, Airport Industria, Cape Town 7915, South Africa
Telephone: +27 21 386 0404, Telefax: +27 21 385 1886
Website: www.mechlift.com, E-mail: info@mechlift.com



DIMENSIONS:

MECHLIFT 220R

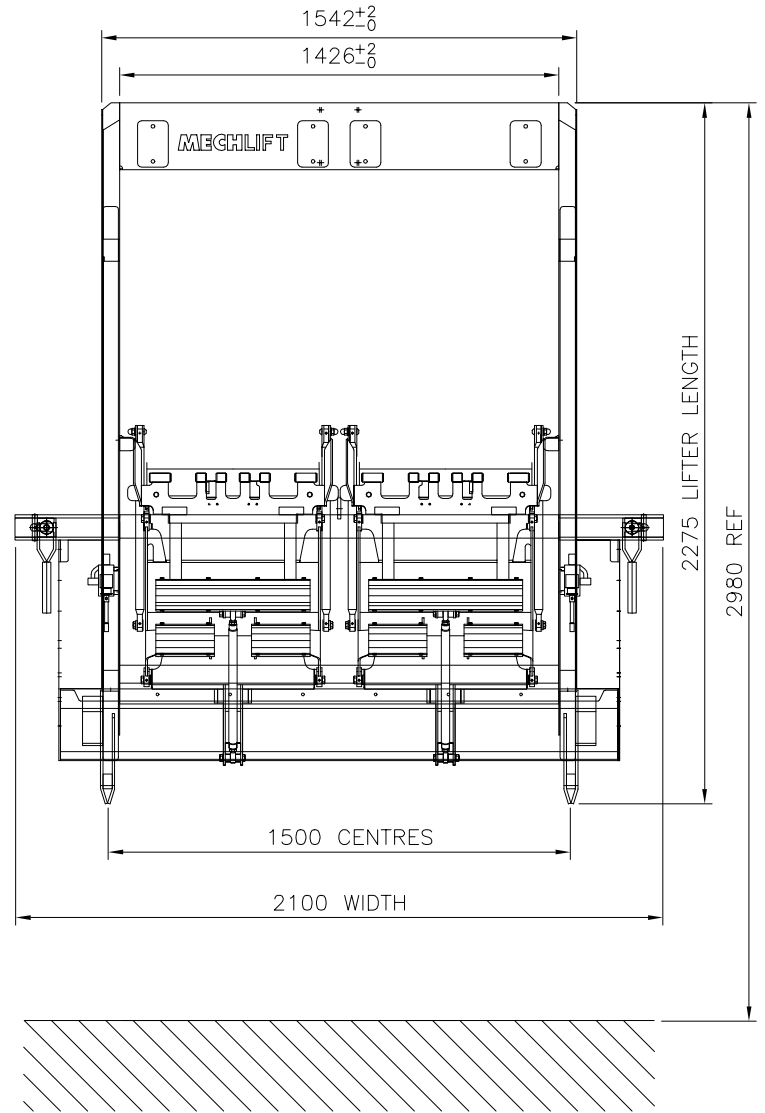
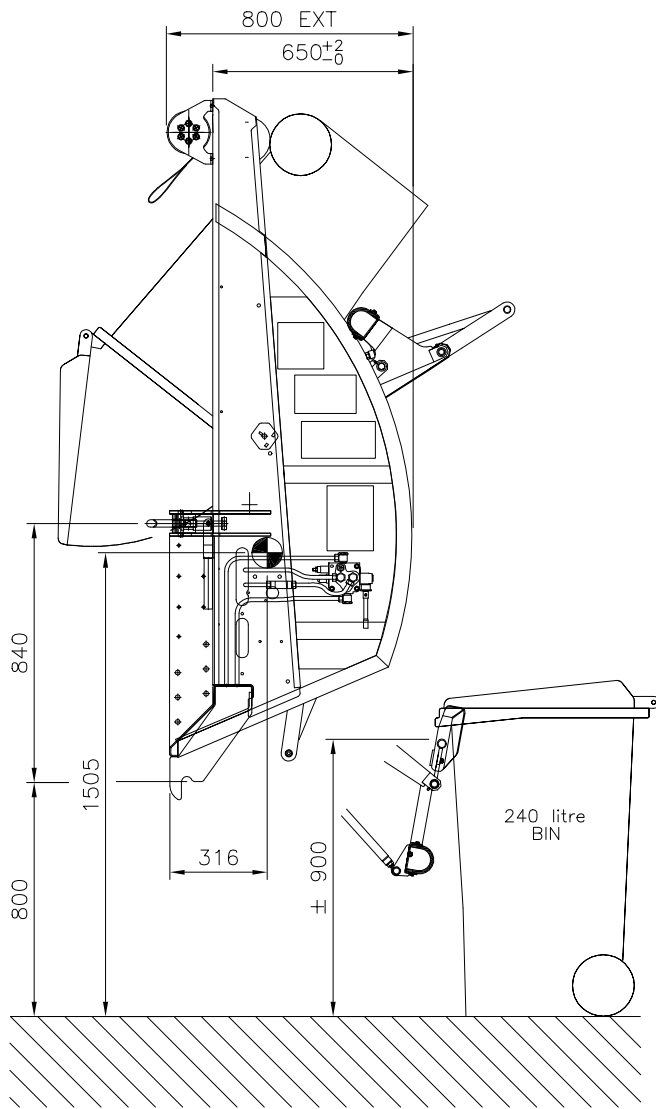

FOR INSTALLATION AND MORE COMPREHENSIVE DETAILS, PLEASE VISIT WWW.MECHLIFT.COM

SPECIFICATIONS:

LIFTER TYPE:	High Level Lifter
BIN TYPE:	1 x 240 litre per lifter (two)
CYCLE TIME:	7 – 8 seconds
TIPPING ANGLE:	55 degrees
LIFTING CAPACITY:	150 Kg per lifter (adjustable limit) (exceeds bin rating by 50%)
HYDRAULIC PRESSURE:	130 bar (relief valve set at 150 bar)
HYDRAULIC FLOW:	18 litre/min for 8 sec. cycle time
NOISE LEVEL:	< 72 dBA
SHIPPING DIMENSIONS:	2275 x 2100 x 800mm
LIFTER MASS:	530 Kgs

FEATURES:

1. Demountable – easily transferred or removed during skip handling
2. No tools – are required to remove the lifter from the truck
3. Winch – a winch overload protection clutch is used to raise and lower the lifter. This slip release mechanism prevents the lifter frame from being bent.
4. Weight – this is kept to the minimum due to the unique frame and rocker combination, thus resulting in bigger pay loads
5. High Level – can still empty bins whilst the truck is compacting

OTHER:

The ML220R has maintenance-free bearings, no flexible hoses (all zinc-plated steel pipes), no exposed cylinder rods to be damaged or ingest dirt.

Damage in the event of an accident is generally inexpensive to repair because of this model's high ground clearance and simple design, this also makes for easy maintenance.